

## Low-Pressure Pneumatically-Actuated Valves

The MEGA-ONE LA is a pneumatically-actuated diaphragm valve for ultra-pure, flammable, or toxic fluid lines for all types of semiconductor equipment and facilities.

The direct diaphragm construction makes the MEGA-ONE LA an industry standard valve with superior sealing performance, remarkable durability, and compactness, while being particle-free and dead-space free.



**Techno Fittings S.r.l.**

**Telephone:** +39 06 8270450 or +39 06 8271242

**Ordering info:** [info@technofittings.com](mailto:info@technofittings.com) **WebSite:** <http://www.technofittings.com/>

# Techno Fittings – Fujikin – MEGA ONE – LA SERIES

## SPECIFICATIONS

Specification	Nominal Diameter	Maximum Operating Pressure	Fluid Temperature Range	Maximum Cv	Actuation Pressure	Connection
	6.35 (1/4")	1MPa	-10~80 °C	0.25	0.34~0.49 MPa	UJR, UPG, F900, Tube Stub
	9.52 (3/8")	145 psi	14~176 °F	0.6	48~70 psi	

● All valves are helium leak tested. Vacuum method/results: External leakage:  $< 5 \times 10^{-12}$  Pa·m<sup>3</sup>/sec. Seat leakage:  $< 5 \times 10^{-12}$  Pa·m<sup>3</sup>/sec  
 ● Demonstrated superior durability - over 4 million cycles (actual test results).

Materials	Part	Material	Temperature/Pressure Rating	
				↑

## DIMENSIONS

Figure 1

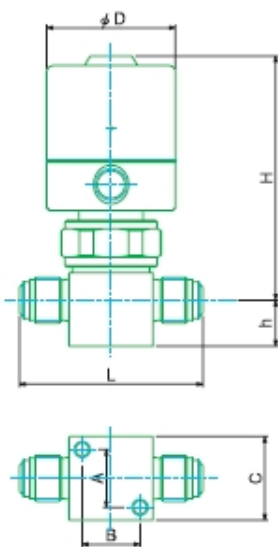

Figure 2

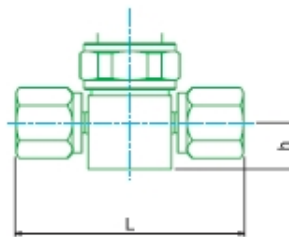

Figure 3

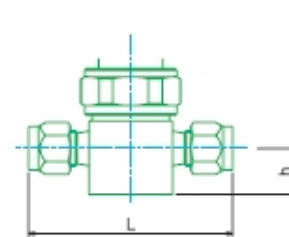

Figure 4

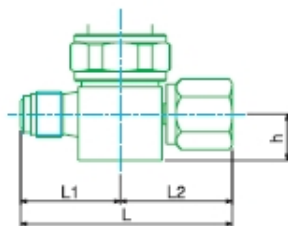

Figure 5

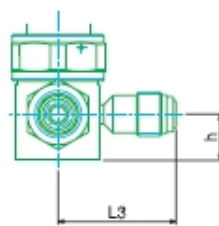
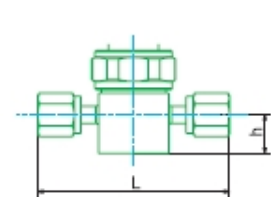

Figure 6



(Unit : mm)

Part Number	Figure	L	L1	L2	L3	h	H	D	A	B	C
FP(R)-UDDF-71-6.35-NL	1	57				14.3	75	40	18	18	26
FP(R)-UDDF-71-6.35-2-NL	2	70.6				14.3	75	40	18	18	26
FP(R)-UDDF-71-9.52-NL	1	76.2				11.1	87.5(82)	50	20.2	20.2	35
FP(R)-UDDF-71-9.52-2-NL	2	83				12.7	87.5(82)	50	20.2	20.2	35
FP(R)-UDDFTB-71-6.35-NL	4	65.7	31	34.7	38.1	14.3	76	40	18	18	26
FP(R)-UDDFTB-71-9.52-NL	4	79.2	37.7	41.5	43.1	12.7	87.5(82)	50	20.2	20.2	35
FP(R)-UDDFTB-71-9.52x6.35-NL	4	69.9	31.8	38.1	38.1	12.7	80.5	40	18	18	26
FP(R)-UDDF-91-6.35-NL	3	63.5				14.3	75	40	18	18	26
FP(R)-UDDF-91-9.52-NL	3	80				12.7	87.5(82)	50	20.2	20.2	35
FP(R)-UDDF-91-12.7-NL	3	85				12.7	87.5(82)	50	20.2	20.2	35
FP(R)-UDDF-71-6.35UG	5	46				14.3	75	40	18	18	26
FP(R)-UDDF-71-6.35UG-2	6	71				14.3	75	40	18	18	26
FP(R)-UDDF-71-9.52UG	5	57				11.1	87.5(82)	50	20.2	20.2	35
FP(R)-UDDF-71-9.52UG-2	6	86				12.7	87.5(82)	50	20.2	20.2	35

( ) Brackets indicate dimensions for normally closed valves. See Figure 1 for dimension keys not shown in other Figures.

## OPTIONS

### Block Valve

FBDV-6,35-2B3-316LP-AQK

Block valve design allows for:

- Compact tubing arrangement
- Dead-space free configuration

In addition to our standard 2-actuator, 3-port block, we also offer custom block valves according to customer's specifications.



FPR-UDDF-71RS2-9,52

### Proximity Sensor

An electrical signal confirms open or closed position of valve. The non-contact proximity sensor offers unsurpassed safety.

### Limit Switch

FPR-UDDF-71LS-6,35-NL

An electrical signal confirms open or closed position of valve.



FPR-UDDF-51-6,35BW-NL-KAG

### Other

Tube stub length may be ordered according to customer specifications.

### IGS Valves

FPR-UDDFA-21-6,35UGF-APD

MEGA series valves are also available in 1,125" and 1,5" W-Seal for surface-mount Integrated Gas Systems.



**Techno Fittings S.r.l.**

**Telephone:** +39 06 8270450 or +39 06 8271242

**Ordering info:** [info@technofittings.com](mailto:info@technofittings.com) **WebSite:** <http://www.technofittings.com/>