

## Techno Fittings – Fujikin – MEGA MINI – LA SERIES

### Compact Low-Pressure Pneumatically-Actuated Valve

The MEGA-MINI LA offers pneumatic operation for ultra-pure, flammable, or toxic fluid lines in various types of semiconductor manufacturing equipment and facilities.

Direct diaphragm construction makes the MEGA-MINI LA an industry standard valve with superior sealing performance, remarkable durability, compactness, and particle and dead-space free performance.

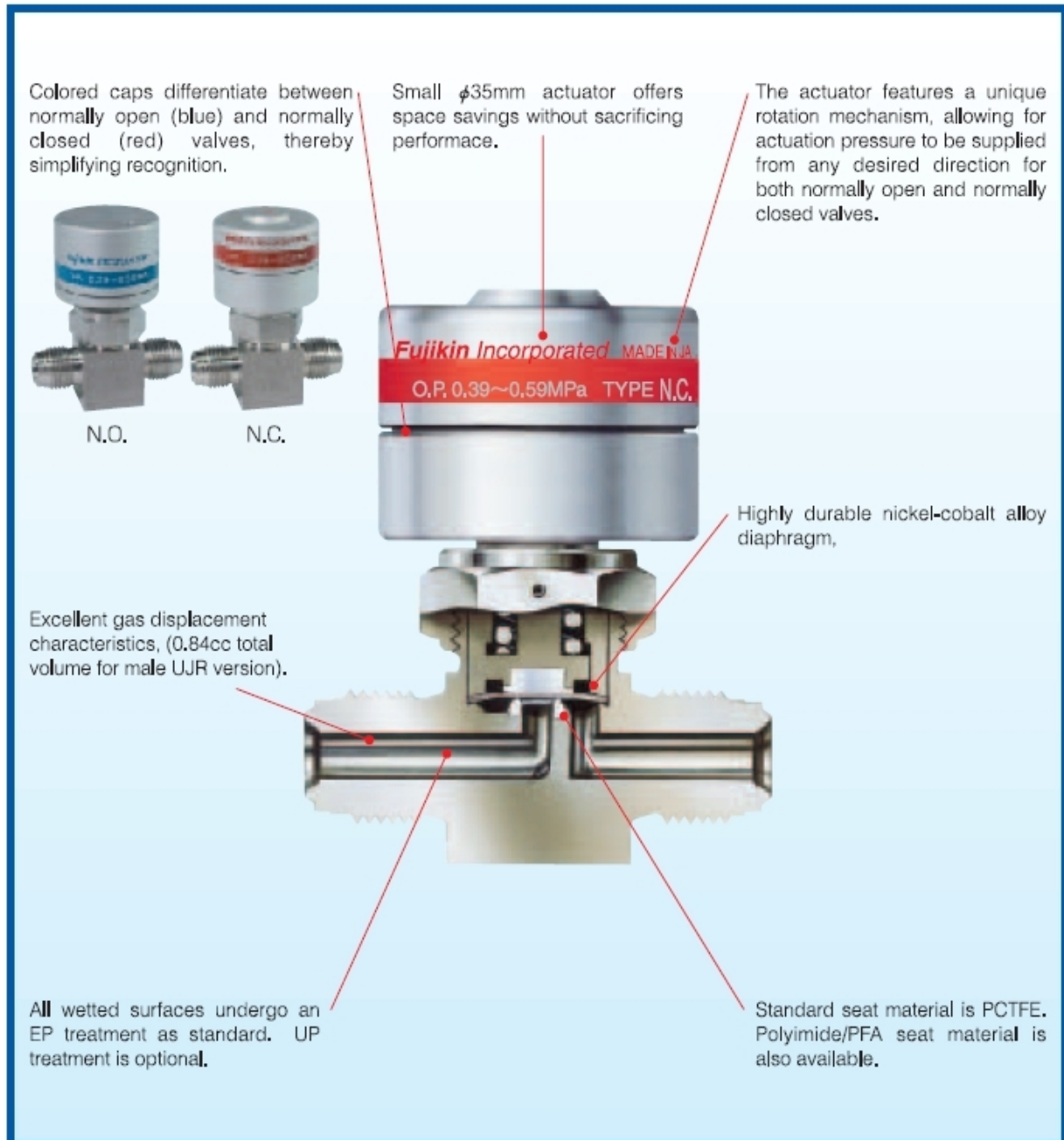

**Techno Fittings S.r.l.**

**Telephone:** +39 06 8270450 or +39 06 8271242

**Ordering info:** [info@technofittings.com](mailto:info@technofittings.com) **WebSite:** <http://www.technofittings.com/>

# Techno Fittings – Fujikin – MEGA MINI – LA SERIES

## SPECIFICATIONS

Specification	Nominal Diameter	Maximum Operating Pressure	Fluid Temperature Range	Maximum Cv	Actuation Pressure	Connection
	6.35 (1/4")	1MPa 145 psi	-10~80 °C 14~176 °F	0.1	0.39~0.59 MPa 56~86 psi	UJR, UPG, F900, Tube Stub

- All valves are helium leak tested. Vacuum method/results: External leakage:  $< 5 \times 10^{-12}$  Pa·m<sup>3</sup>/sec. Seat leakage:  $< 5 \times 10^{-12}$  Pa·m<sup>3</sup>/sec
- Demonstrated superior durability - over 4 million cycles (actual test results).

Materials	Part	Material
	Body	SUS316L
	Diaphragm	Nickel-cobalt alloy
	Seat Packing	PCTFE
	Actuator	A5056

Temperature/Pressure Rating

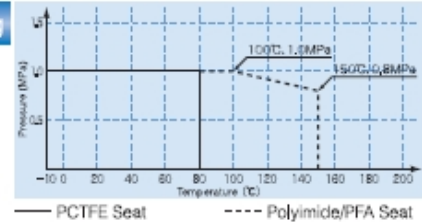

## PART NUMBER DESIGNATION

Please use the part number designations below when placing an order.

FPR-SD [ ] -71 [ ] -6.35 [ ] - [ ] - [ ]

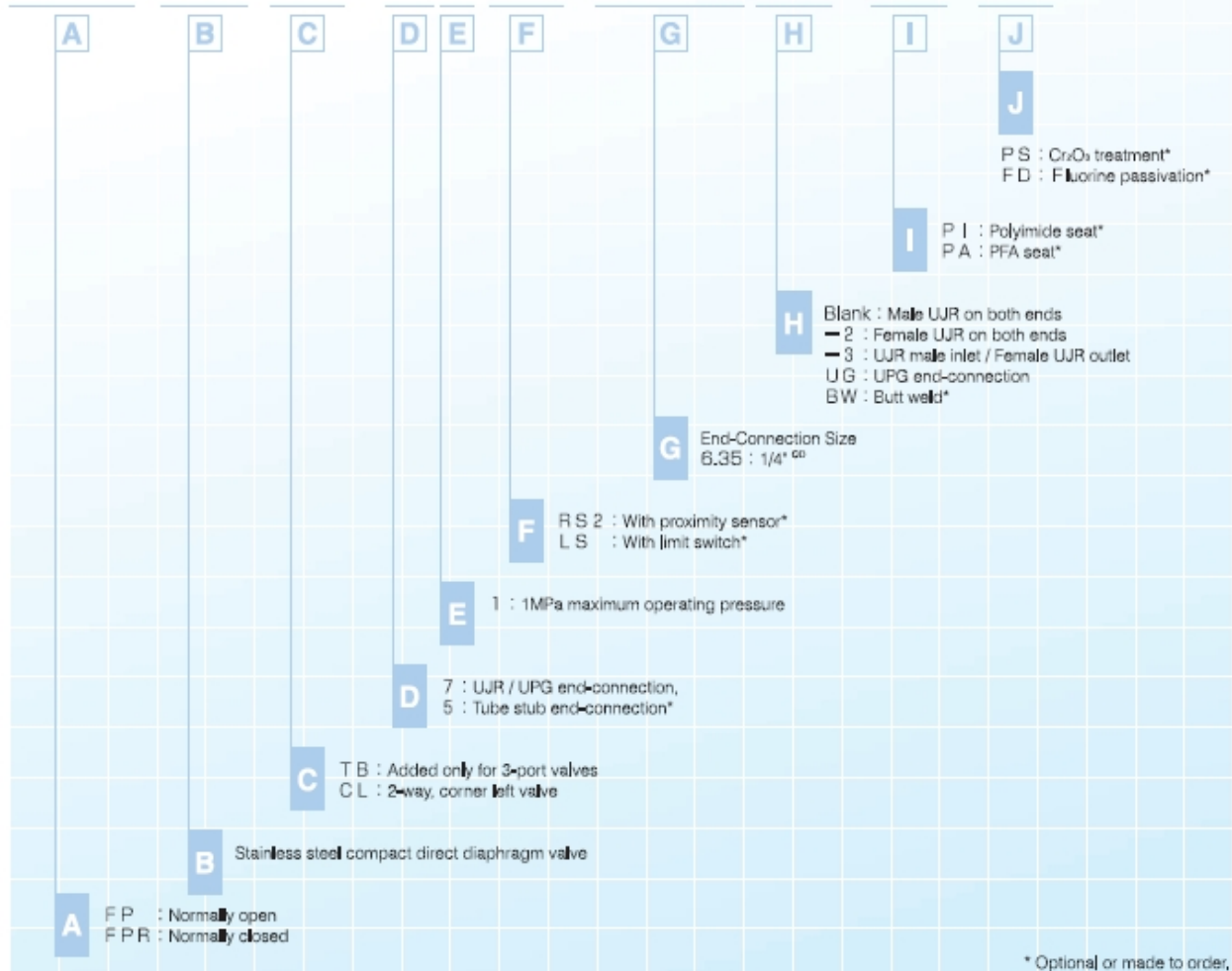

Actual shipped products may have additional designations (such as #A, #B) in the part number. These indicate production history and do not indicate a change in function or dimensions.

**Techno Fittings S.r.l.**

**Telephone:** +39 06 8270450 or +39 06 8271242

**Ordering info:** [info@technofittings.com](mailto:info@technofittings.com) **WebSite:** <http://www.technofittings.com/>

# Techno Fittings – Fujikin – MEGA MINI – LA SERIES

## DIMENSIONS

Figure 1

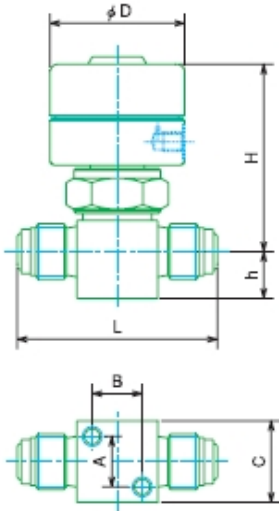

Figure 2

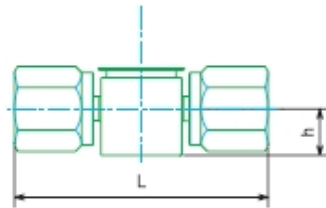

Figure 3

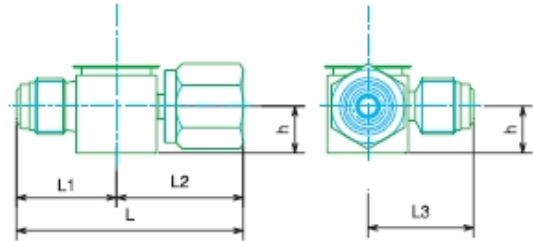

Figure 4

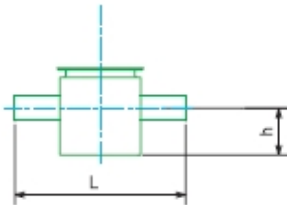

Figure 5

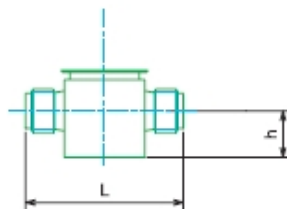
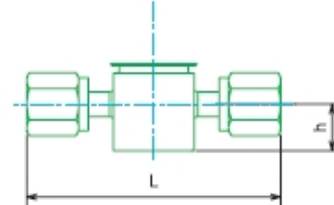

Figure 6



Part Number	Figure	(Unit : mm)									
		D	L	H	h	A	B	C	L1	L2	L3
FP(R)-SD-71-6.35	1	35	52	50.5	12	13	13	21			
FP(R)-SD-71-6.35-2	2	35	66	50.5	12	13	13	21			
FP(R)-SDTB-71-6.35	3	35	59	50.5	12	13	13	21	26	33	27.5
FP(R)-SD-51-6.35BW-FFL	4	35	44.4	50.5	12	13	13	21			
FP(R)-SD-71-6.35UG	5	35	41	50.5	12	13	13	21			
FP(R)-SD-71-6.35UG-2	6	35	66	50.5	12	13	13	21			

※ See Figure 1 for dimension keys not shown in other Figures.

**Techno Fittings S.r.l.**

**Telephone:** +39 06 8270450 or +39 06 8271242

**Ordering info:** [info@technofittings.com](mailto:info@technofittings.com) **WebSite:** <http://www.technofittings.com/>

## OPTIONS

### Block Valve

FBSDV-6.35-2B3-BGB

Block valve design allows for:

- Compact tubing arrangement
- Dead-space free configuration

In addition to our standard 2-actuator, 3-port block, we also offer custom block valves according to customer's specifications.

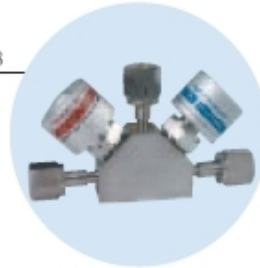

FPR-SD-71SS2-6.35

### Dual-Flow Valve

Allows for switching between maximum flow and a user-selectable reduced flow with one valve.

### Proximity Sensor

FPR-SD-71RS2-6.35

An electrical signal confirms open or closed position of valve. The non-contact proximity sensor offers unsurpassed safety.



FPR-SD-71LS-6.35

### Limit Switch

An electrical signal confirms open or closed position of valve.

### Other

A variety of configurations are possible.



FPR-SD-51-6.35-FFL



FPR-SDCR-71-6.35-ANU



FPR-SDXR-71-6.35-2



FPR-SDA-21-6.35UGF-APD

### IGS Valves

MEGA series valves are also available in 1.125" and 1.5" W-Seal for surface-mount Integrated Gas Systems.

Photos are samples of each product type.

**Techno Fittings S.r.l.**

**Telephone:** +39 06 8270450 or +39 06 8271242

**Ordering info:** [info@technofittings.com](mailto:info@technofittings.com) **WebSite:** <http://www.technofittings.com/>